

**Inside this issue**

- Editor's Letter
- October Meeting Details
- September Meeting Recap
- Student Chapter Update
- 2010 Vendor Fair
- 2011 Directory Forms
- 2010 Programs Schedule
- Certification Matrix
- Executive Board Contacts
- Newsletter Submission Schedule

**Next Board Meeting**

**October 25th, 2010**  
**St. Thomas Academy**  
**949 Mendota Heights Road**  
**Mendota Heights, MN 55120**  
*Please contact one of the Board Members if you would like to attend.*

**Contact AFE Chapter 13**

**1960 Cliff Lake Road**  
**Suite 129-409**  
**Eagan, MN 55122**

**651-895-3502**  
**651-905-9535 fax**

**www.afetwincities.org**  
**contact@afetwincities.org**

**Contact AFE National HQ**

**12801 Worldgate Drive**  
**Suite 500**  
**Herndon, VA 20170**

**571-203-7171**  
**571-766-2142 fax**

**www.afe.org**  
**info@afe.org**

**Letter from the editor**



*Paul Solmon, CPMM*  
*St. Thomas Academy*

Dear Fellow Members and Sponsors:

Indian Summer or another instance of Global Warming? I am not entirely sure, but Autumn in Minnesota is in full bloom. Enjoy!

The October 18th meeting marks the final tour of 2010. This is a special event as the sponsor, Harris Controls, will be conducting a comprehensive tour of St. Joseph's Catholic K-8 School and The Church of St. Joseph's in Rosemount. These two connected facilities were featured on the cover of the 2010 Directory of Members and Sponsoring Companies as the Project Showcase winner for the integration of green and sustainable construction applications. Attendees will have a chance to tour the 44,000 sq. ft. addition which features a Central Plant GeoEx-



change Water-to-Water Hydronic Heat Pump System. Harris Controls also installed a 40 panel direct heat solar panel system designed to recharge the GeoExchange ground loop fields. This is a very compelling application. A detailed presentation will be given by Brian Cornelisse with Harris Controls on some of the key features of this unique facility. Nominations and voting for the Secretary position for the Board of Directors will also occur at this meeting. Hope to see you there!

Thank you to all who attended the September AFE Meeting at Vadnais Heights Sports Complex sponsored by Schwickerts. A special thanks goes out to Kristi Dohrman for directing the event; Ted Clavel for the tour and technical presentation and all the great folks at Schwickerts for providing the excellent dinner from Sak's Sports Bar. The Vadnais Heights Sports Complex consisted of an arena building with two sheets of ice, locker rooms, and an attached year round inflatable dome. Recent publicity prompted legislative action to improve the indoor air quality in ice arenas, and Vadnais Heights Sports Complex is the first new facility to be built since that action. The ventilation equipment for the ice arenas was designed to utilize desiccant wheels, heat recovery wheels, air quality sensors, and variable frequency drive technologies to provide the mandated indoor air quality requirements without the normal high operating cost usually associated with meeting high ventilation air requirements.



Our 2010 meeting schedule concludes with the 11th Annual Vendor Fair & Awards Banquet. Vendor registration forms are included in this newsletter. If you are interested in this event, please complete the registration form quickly as this event has filled out the previous 10 years. An attendee RSVP form is also included for your convenience.

Lastly, AFE Twin Cities Chapter 13 is in the planning stages for securing CPE, CPMM, and CPS review classes and Certification Exams to be conducted in the Twin Cities area. AFE National is providing labor and finances to support this initiative. This may be the just the right opportunity to look closely at obtaining the industries most recognized certifications.

Mark your calendar for these last two events! We really hope to see you this fall!

Sincerely,

Paul Solmon, CPMM  
1st Vice President  
Program Chair & Newsletter Editor  
St. Thomas Academy, (651) 683-1536  
paulsolmon@yahoo.com

**Commitment—Interaction—Growth**



**October Meeting Info**

**When:** October 18th, 2010  
**Registration:** 5:00pm  
**Tour:** 5:15pm  
**Dinner:** 6:00pm  
**Presentation:** 6:30pm  
**Where:** St. Joseph's K-8 School  
 Church of St. Joseph's  
 13900 Biscayne Ave West  
 Rosemount, MN 55068  
 (651) 423-1658  
**Cost:** Members \$15  
 Guests \$20  
**RSVP:** Please RSVP no later than 1:00pm on  
 Friday, October 15th, 2010



**St. Joseph's Catholic K-8 School  
 Church of St. Joseph's Facility Tour**

Please join us for the final tour of 2010. This is a special event as the sponsor, Harris Controls, will be conducting a comprehensive tour of St. Joseph's Catholic K-8 School and The Church of St. Joseph's. These two connected facilities were featured on the cover of the 2010 Directory of Members and Sponsoring Companies as the Project Showcase winner for the integration of green and sustainable applications. A detailed presentation will be given by Brian Cornelisse with Harris Controls on some of the key features of this unique facility. The completed Project Showcase submittal is featured on the next three pages. Hope to see you there!

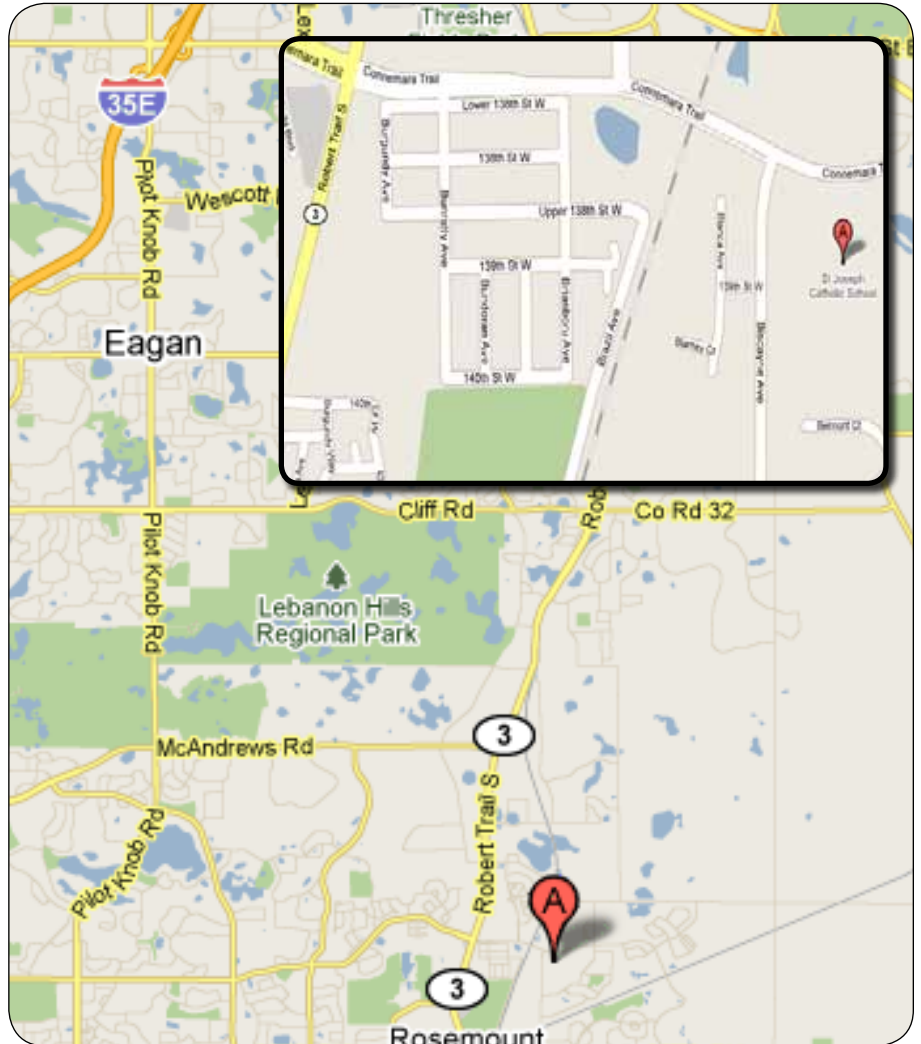

**Call to RSVP at 651-895-3502 or fax this reservation form to 651-905-9535 or email at [contact@afetwincities.org](mailto:contact@afetwincities.org). Please make reservations for \_\_\_\_\_ members and \_\_\_\_\_ guests to attend the AFE Meeting.**



Name

Company

1. \_\_\_\_\_

\_\_\_\_\_

2. \_\_\_\_\_

\_\_\_\_\_

3. \_\_\_\_\_

\_\_\_\_\_



**A**FE Association for  
**FACILITIES**  
**ENGINEERING**®

**2010 Directory of  
Members and  
Sponsoring Companies**

**The Annual Guide to  
Professional Resources**

**Twin Cities Chapter 13**

*Read front and back covers to learn more about this amazing picture!*

# Church of St. Joseph's St. Joseph's Catholic K-8 School

Rosemount, MN

## Project Showcase Summary

### Overview:

The Church of St. Joseph is a Catholic parish with K-8 Catholic school curriculum located in Rosemount, MN. The church and school were in a transition period. The parish moved the sanctuary from their old site in 2007 to their current location. With financing in place and approval from the Arch Diocese, the church was able to construct a new 44,000 sq. ft. addition to their existing building to house their K-8 education program, which was still operating at the old location.

The new addition consists of a large social hall and kitchen, eleven classrooms, a library, a computer room, administration space, shipping and receiving, and a gymnasium with storage and future locker rooms.

This project was originally under design using conventional gas fired/DX mechanical systems. The church priest has a passion for GeoExchange systems based upon his experience with these types of systems in North Dakota. After the church was presented with two water-to-air heat pump system options, the project architect brought TRAK International in to make a presentation to the construction team on their unique GeoExchange system that uses central plant water-to-water heat pumps with a four-pipe individual zone fan coil arrangement and several energy recycling components.

A church or school is an ideal candidate for implementing a GeoExchange system because they will own and operate the building for many years. The increased initial construction costs generally result in an increased monthly mortgage payment. However, the utility expense savings month after month by installing a high performance, energy efficient mechanical system is usually greater than that of the added principal to the mortgage. This cash flow scenario results in a positive cash flow situation from day one.

### Details:

The original building construction consists of a sanctuary and narthex of 17,700 sq. ft. This structure is heated and cooled using a conventional mechanical system consisting of boiler generated hot water and an air-cooled condensing unit for cooling the sanctuary. In addition, the complex houses an administration and meeting space of 10,800 sq. ft. The ancillary space is cooled with two independent DX rooftop air handling units and heated with hot water zone coils.

The energy efficient TRAK International GeoExchange system consists of ground source heat pumps, solar panels, energy recovery coils, borefield and a building management system.

Two (60) ton water-to-water hydronic heat pumps were implemented to provide simultaneous heating and cooling to zone fan coils. One (10) ton water-to-water heat pump with a double wall heat exchanger was used to provide domestic hot water for the building. These industrial quality heat pumps are custom designed for each project by TRAK International and manufactured at Harris' fabrication shop, Midwest Fabrication and Supply (MFS) located in Zumbrota, MN.

Forty solar panels provide "free" direct heating, or source heat for the heat pumps, or recharging of the ground loop depending upon which control sequence is initiated. The location of the panels on the roof saved general construction costs because the city officials allowed the solar panels to be used as rooftop air handling unit screen wall in lieu of a manufactured system for some of the views.

*details continued on inside back cover*



### Client: Church of St. Joseph

Gary Mitchell, Business Administrator  
Scott Kaufman, Facilities Administrator  
13900 Biscayne Avenue West  
Rosemount, MN 55068  
Project Cost: \$1.5 Million

# Church of St. Joseph's St. Joseph's Catholic K-8 School

Rosemount, MN

## Project Showcase Summary *(continued)*

Two energy recovery coils reclaim waste heat from the exhaust and building relief air streams and put it back into the heating or cooling systems depending upon which control sequence is initiated. Six circuits of 10 boreholes each compose the ground loop capacitor. Each hole was drilled to approximately 165' deep. The location and orientation of the borefield proved to be challenging due to existing restrictions of the site including; building location, a city easement, landscaping and utilities.

In addition, the team worked around the possible expansion of two educational wings. Each of these items were drawn to scale on the site plan and every borehole was individually located around these obstacles and the information was relayed to the well driller.

The TRAK system incorporates the use of a KMC building automation system that operates the heat pumps, air handling units, fan coils and several control valves to direct heating or cooling fluid and distribute the recycled energy for maximum system efficiency and performance. This web enabled system provides the operations staff to see their systems operational performance from any place at any given time.

Installing a ground source water-to-water heat pump central plant resulted in general construction cost savings as well. TRAK International and Harris Companies were able to design and build the central plant within the boundaries of their existing mechanical and electrical room. Harris Companies detailed the new mechanical system using a 3D modeling program. This information was sent to MFS for full fabrication of the mechanical room piping.

Taps were provided to cross connect their existing mechanical system in the future to supplement their current heating and cooling needs. If this is implemented, the TRAK system may be able to alleviate the use of their conventional system during the shoulder seasons and greatly reduce operation of the equipment during the rest of the year.

### Contact Information:

Brian Cornelisse, Controls Account Manager  
Harris Companies  
909 Montreal Circle, St. Paul, MN 55102  
Tel: 651-602-6573, bcornelisse@hmcc.com

### Project Team:

Steve Lutz, PE, LEED AP, TRAK International, Engineer of Record  
Mike Biebl, LEED AP, Harris Companies, Mechanical Project Manager  
Chris Ehly, Harris Companies, Prefabrication Detailer  
Mike Ostertag, Harris Companies, Pipe Fitter Foreman  
Ken Schmidt, Harris Companies, Plumber Foreman  
Don Avery, Harris Companies, Sheetmetal Foreman  
Glen Dahn, Harris Companies, Control Engineer  
Gary Mitchell, Church of St. Joseph, Business Administrator  
Scott Kaufman, Church of St. Joseph, Facilities Administrator  
Rich Pelletier, Greystone Construction, General Contractor

### Equipment Utilized:

Hydronic Water-to-Water Heat Pumps  
Domestic Water-to-Water Heat Pumps  
Intelligent TRAK Energy Device Box  
Temperature Controls  
Rooftop Air Handling Units  
Heat Recovery Coils  
Exhaust Fans  
Pumps  
Variable Frequency Drives  
Fan Coils  
Cabinet Unit Heaters  
Solar Panels

TRAK International  
TRAK International  
TRAK International  
KMC  
McQuay  
Greenheck  
Greenheck  
Bell and Gossett  
ABB  
First Company  
Rittling  
Solar Skies MFG

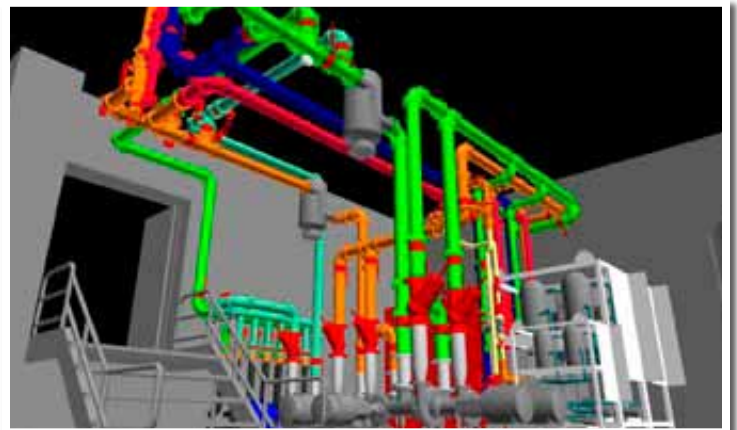

### GeoExchange System Summary

- 60 borehole, GeoExchange well field
- Free heating energy through 40 solar panels
- Energy recovery coils on building relief & exhaust systems
- Two – 60 ton custom hydronic heat pumps
- One – 10 ton custom domestic water heat pump
- Simultaneous heating/cooling for each zone year round.
- 3D modeling of the Mechanical Room
- Design/Build mechanical construction

**Vendor Fair & Awards Banquet Meeting Info**



*11th Annual*  
**VENDOR FAIR &  
 AWARDS BANQUET**  
*November 15, 2010*

**When:** November 15, 2010  
**Setup Hours:** 2:30-4:00pm  
**Exhibit Hours:** 4:00-6:45pm  
**Dinner & Awards:** 7:00-8:30pm  
**Where:** Jax Cafe, 2nd floor  
 1928 University Ave NE  
 Minneapolis, MN 55418  
 Ph (612) 789-7297  
 www.jaxcafe.com  
**Cost:** Members \$15 & Guests \$20  
**RSVP:** Please RSVP no later than 1:00pm on  
 November 12, 2010

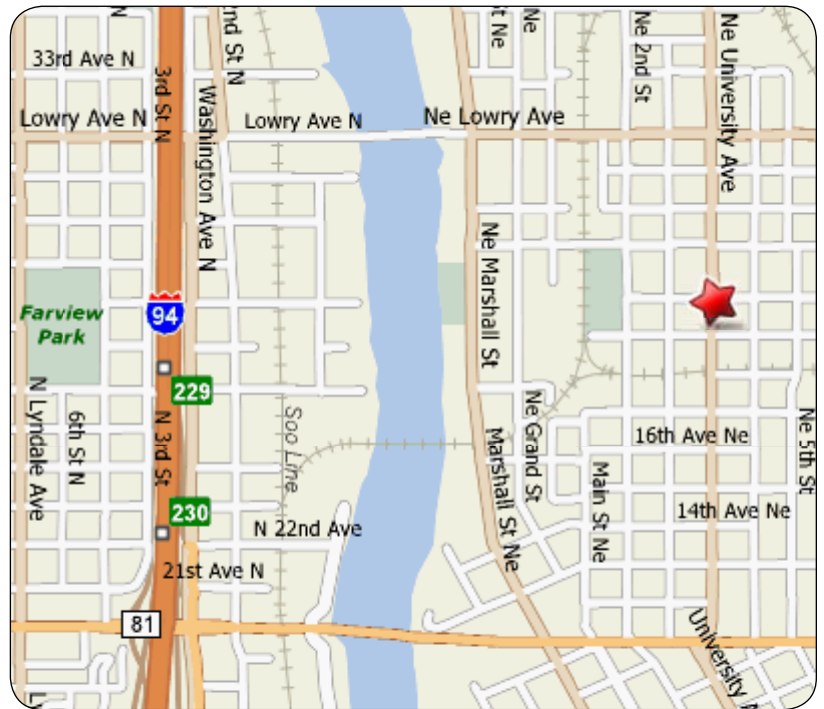

**Call to RSVP at 651-895-3502 or fax this reservation form to 651-905-9535 or email at [contact@afetwincities.org](mailto:contact@afetwincities.org).**

**Please make reservations for \_\_\_\_\_ members and \_\_\_\_\_ guests to attend the AFE Meeting.**

- Meal Choices:** 1. Filet Mignon with Bordelaise Sauce, Garlic Mashed Potatoes, Fresh Vegetables, and Dessert  
 2. Broiled Walleye Pike with New Potatoes, Fresh Vegetables, and Dessert



<u>Name</u>	<u>Company</u>	<u>Meal Choice</u>
1. _____	_____	_____
2. _____	_____	_____
3. _____	_____	_____

## September Meeting Recap

Thank you to all who attended the September AFE Meeting at Vadnais Heights Sports Complex sponsored by Schwickerts. A special thanks goes out to Kristi Dohrman for directing the event; Ted Clavel for the tour and technical presentation and all the great folks at Schwickerts for providing the excellent dinner from Sak's Sports Bar.

Sponsored by



The Vadnais Heights Sports Complex consisted of an arena building with two sheets of ice, locker rooms, and an attached year round inflatable dome. Recent publicity prompted legislative action to improve the indoor air quality in ice arenas, and Vadnais Heights Sports Complex is the first new facility to be built since that action. The ventilation equipment for the ice arenas was designed to utilize desiccant wheels, heat recovery wheels, air quality sensors, and variable frequency drive technologies to provide the mandated indoor air quality requirements without the normal high operating cost usually associated with meeting high ventilation air requirements.



## Student Chapter Update

On September 17, 2009, University of Wisconsin Stout presented scholarships to over 300 students valued at more than \$500,000 for the 2010-2011 academic year. AFE Twin Cities Chapter 13 donated \$3,000 toward these scholarships.

Proceeds generated from the 22nd Annual Lucky 13 Golf Tournament provided the source of this donation. Thank you to all who participated and helped coordinate this terrific event.

A big thanks also goes out to Tom Westby for his efforts in 2010 toward the Student Chapters at UW Stout and Century College. The photo below was taken at the Stout University Foundation Scholarship Awards Ceremony. Included in the photo are from left to right Jerry Hagen, CPE, Garrett Fravert, Royce Schulte and Scott Webster. Not pictured is Vance Grubbs. Each student received \$1,000.





*11th Annual*  
**VENDOR FAIR &  
AWARDS BANQUET**  
*November 15, 2010*

August 17, 2010

Dear Sponsoring Company:

On behalf of AFE Twin Cities Chapter 13, we would like to extend an invitation for you and your company to participate in our 11th Annual Vendor Fair & Awards Banquet to be held on November 15, 2010. This event has consistently been rated the best event of the year by both members and participating sponsors.

Jax Cafe' in Minneapolis will again be the venue for this event. The location, size, amenities, and exceptional food make this venue an ideal choice for our event.

There are three main components of the Annual Vendor Fair & Awards Banquet:

1. Tabletop exhibits by our sponsoring companies
2. Awards and recognition for members and sponsors
3. Installation of 2011 Executive Board of Directors

The tabletop exhibits offer a slightly more intimate opportunity to share capabilities and meet facility professionals from AFE Twin Cities Chapter 13. Members are required to visit each exhibit to be eligible for valuable prize drawings. The atmosphere is lively and fast paced.

Following the exhibits, dinner is served. This year Jax Cafe' is once again offering their famous Filet Mignon in addition to fresh, broiled Canadian Walleye Pike and Chicken Chardonnay. During dinner, we will be recognizing members and sponsors for their exceptional contributions during 2010. This ceremony has become an honored tradition and affords recipients to share their reflections.

Lastly, we conclude the evening with the official Installation of Officers. In accordance with our bylaws, the 2011 AFE Twin Cities Chapter 13 Board of Directors will be introduced and sworn in with a special award presented to the outgoing President.

Please take a minute to look over and complete the attached application and fax it to us right away. There is only enough space at Jax Cafe' for 29 exhibitors. We have filled out each of the past ten years.

Again, please accept this invitation to be part of this exciting event. We look forward to seeing you and your companies display of facility based products and services. Should you have any questions, please do not hesitate to contact us.

Best regards,

Paul Solmon, CPMM  
St. Thomas Academy  
Vendor Fair & Awards Banquet Committee Chair



## Exhibitor Application

Company Name \_\_\_\_\_

Address \_\_\_\_\_ City \_\_\_\_\_ State \_\_\_\_\_ Zip \_\_\_\_\_

Phone \_\_\_\_\_ Fax \_\_\_\_\_ Preferred Email \_\_\_\_\_

Attendee 1 \_\_\_\_\_ Meal Choice # \_\_\_\_\_

Attendee 2 \_\_\_\_\_ Meal Choice # \_\_\_\_\_

Attendee 3 \_\_\_\_\_ Meal Choice # \_\_\_\_\_

Attendee 4 \_\_\_\_\_ Meal Choice # \_\_\_\_\_

**Cost:** \$350.00 (includes 2 meals, 6 foot table, and electrical hookup)      Extra Meals \$35 each      Total \_\_\_\_\_

**Raffle Item:** Donation of a raffle item/s is requested. Your company may raffle off the winner and present the raffle item. Drawings will be held throughout the evening.

**Meal Choices:**

1. Filet Mignon with Bordelaise Sauce, Garlic Mashed Potatoes, Fresh Vegetables, and Dessert
2. Broiled Walleye Pike with New Potatoes, Fresh Vegetables, and Dessert

**Location:** Jax Cafe, 2nd floor, 1928 University Ave NE, Minneapolis, MN 55418, Ph (612) 789-7297, [www.jaxcafe.com](http://www.jaxcafe.com)

**Setup Hours:** 2:30-4:00pm      **Exhibit Hours:** 4:00-6:45pm      **Dinner, Program, Awards:** 7:00-8:30pm

**Payment Info:** AFE accepts check or credit card. Please make checks payable to AFE Chapter 13. Credit card info is listed below. Please mail completed form and payment to AFE Chapter 13, 1960 Cliff Lake Rd, Suite 129-409, Eagan, MN 55122.



CC# \_\_\_\_\_ Exp Date \_\_\_\_\_ 3 or 4 digit code on back \_\_\_\_\_



Name on Credit Card \_\_\_\_\_



Billing Address of Credit Card \_\_\_\_\_



### Important Information

There is only enough space for 29 Exhibitors at Jax Cafe. Please fax your completed application as soon as possible to Joe Ryan at (651) 905-9535.

The first 29 applications will be accepted. Notification will be sent confirming your space along with a floor diagram. If you have any questions, please contact Joe Ryan at (651) 895-3502, [contact@afetwincities.org](mailto:contact@afetwincities.org) or Paul Solmon, CPMM at (651) 683-1540 or [paulsolmon@yahoo.com](mailto:paulsolmon@yahoo.com). Thank you

August 2010

Dear Sponsor:

Our Board of Directors and members would like to invite your company be a sponsor of AFE Twin Cities Chapter 13. **Your support means very much to our organization.** Your support of the directory helps to finance AFE Twin Cities Chapter 13 programs such as facilities engineering scholarships, educational activities, monthly meeting expenses, and involvement in AFE National programs. We would also like to extend our gratitude to previous and existing sponsors for their ongoing support of AFE Twin Cities Chapter 13 Directory.

Each year, AFE Twin Cities Chapter 13 prints its directory, which contains up-to-date contact information for more than 250 members. As a sponsor, your complete contact information and a detailed description of your products and services will be listed in the directory. This serves as a handy reference guide for our members to obtain your products and services and as a source of contacts for your sales personnel. Each of our members and sponsoring companies receives a copy of the directory in January. With your copy, you will have contact information for decision-makers in the facilities, maintenance, and engineering departments of most of the Twin Cities' leading companies. Also included is an emailed version of our monthly newsletter to your designated contact. By being a sponsor, you are also given the opportunity to advertise in our monthly newsletter. We sincerely hope you see the benefits of listing your organization in our directory.

The minimum ad is only \$100 for full company contact information and 6 lines of text. A line is 48 characters long. Please see sample below.

**ABC Company**

*Primary Contact*

Phone 1: 651-123-4567 Phone 2: 651-234-5678

Fax: 651-345-6789

678 Any Street., Minneapolis, MN 55044

Email: primarycontact@abccompany.com

Website: www.abccompany.com

**Products/Services**

Mechanical & Temperature control, service & installation, including: building automation, pneumatics, steam trap testing, surveys, troubleshooting. Boilers, burners, RTU's, chillers & DX systems. Hydronic & steam systems, piping, ventilation & heat recovery.

Included in the directory is a list of sponsors categorized by area of specialty. With the cost above, your company will be listed on **(2) specialty listings**. To be listed under more than two specialty headings, the cost is \$10 for each additional specialty heading. In addition to the text ad, a display/showcase ad can be put into the directory for an additional fee as shown below.

	<b>Black &amp; White Printing</b>	<b>Color Printing</b>
¼ page display	\$100	\$350
½ page display	\$175	\$450
1 page display/showcase ad	\$300	\$550
1 Page Inside Back Cover display/showcase ad	\$600	\$700
1 Page Back Cover display/showcase ad	\$700	\$800

**To participate:**

1. Complete the attached **Directory Advertising Form or Project Showcase Directory Cover Form and/or the enclosed invoice.**
2. If running a display/showcase ad, please email electronic artwork to [contact@afetwincities.org](mailto:contact@afetwincities.org) or **enclose camera-ready artwork.**
3. **Please send a check** (payable to AFE Twin Cities Chapter 13) and the above items to the address below.

If you have any questions and/or require additional information, please feel free to contact Al Meinke at 651-234-6902 or Joe Ryan (Directory Committee and Administrative Assistant) at 651-895-3502.

Sincerely,

*Al Meinke*

Sponsoring Companies and Directory Chair

# DIRECTORY AD FORM

Company \_\_\_\_\_  
 Primary Contact \_\_\_\_\_  
 Address \_\_\_\_\_  
 City, State, Zip \_\_\_\_\_  
 Phone \_\_\_\_\_ Fax \_\_\_\_\_ Mobile Phone \_\_\_\_\_  
 Email \_\_\_\_\_  
 address \_\_\_\_\_ Website \_\_\_\_\_

Products/Services Description (4-6 lines of text): \_\_\_\_\_  
 \_\_\_\_\_  
 \_\_\_\_\_  
 \_\_\_\_\_

Referred by: (if new sponsor) \_\_\_\_\_

**SPECIALTY LISTINGS – TWO INCLUDED IN BASE PRICE.  
 ADDITIONAL AT \$10/SPECIALTY:**

- \_\_\_\_\_ Alarms, Access Control, Fire Protection
- \_\_\_\_\_ Asbestos Abatement
- \_\_\_\_\_ Cleaning Equipment & Services
- \_\_\_\_\_ Cleanrooms
- \_\_\_\_\_ Communication – Material & Services
- \_\_\_\_\_ Compressors
- \_\_\_\_\_ Construction – Material Service & Systems
- \_\_\_\_\_ Controls – Material Service & Systems
- \_\_\_\_\_ Electrical Material & Services
- \_\_\_\_\_ Energy Fuels
- \_\_\_\_\_ Engineering Consultants
- \_\_\_\_\_ Environmental Services
- \_\_\_\_\_ Filters
- \_\_\_\_\_ Fire Life Safety
- \_\_\_\_\_ Generators
- \_\_\_\_\_ Heat Transfer-Boilers and Burners
- \_\_\_\_\_ Heat Transfer - Cooling Towers
- \_\_\_\_\_ HVAC, Sheet Metal, Plumbing
- \_\_\_\_\_ Indoor Air Quality
- \_\_\_\_\_ Insulation Material & Services
- \_\_\_\_\_ Lighting - Material & Services
- \_\_\_\_\_ Lubricants, Hydraulic Oils, Oil Analysis
- \_\_\_\_\_ Machining, Metal Fabrication, Welding
- \_\_\_\_\_ Mechanical Power Transmission
- \_\_\_\_\_ Mechanical - Material & Services
- \_\_\_\_\_ Personnel Protective Equipment & Supplies
- \_\_\_\_\_ Power Distribution
- \_\_\_\_\_ Pneumatic Equipment

- \_\_\_\_\_ Power Transmission
- \_\_\_\_\_ Pumps
- \_\_\_\_\_ Recycling Services
- \_\_\_\_\_ Roofing Material & Services
- \_\_\_\_\_ Services – Painting, Cleaning, Interior Design
- \_\_\_\_\_ Services – Excavating, Paving, Snow Removal
- \_\_\_\_\_ Services – Grounds, General Waste Collection
- \_\_\_\_\_ Services – Special
- \_\_\_\_\_ Software and Hardware Services, CAD, etc.
- \_\_\_\_\_ Surfaces – Scaling, Abrasion/Corrosion
- \_\_\_\_\_ Surfaces – Control/Coatings
- \_\_\_\_\_ Water Treatment – Chemicals & Equipment

**Write in your own specialty.**

\_\_\_\_\_  
 \_\_\_\_\_

**CALCULATE TOTAL COST HERE**

<b>Base Ad with 2 free specialty listings included.</b>		<b>\$100.00</b>
<b>Add Specialty Listings \$10 each</b>		
	<b>B/W Ad</b>	<b>Color Ad</b>
¼ page Display Ad	\$100	\$350
½ page Display Ad	\$175	\$450
1 Page Display or Showcase Ad	\$300	\$550
<b>Premium Locations</b>		
1 Page Inside Back Cover Ad	\$600	\$700
1 Page Back Cover Ad	\$700	\$800
	<b>Total</b>	

Artwork deadline is **November 19, 2010**. Electronic artwork should be emailed to [contact@afetwincities.org](mailto:contact@afetwincities.org) Camera ready or hard copy artwork should be mailed with your payment.

If you have any questions or require additional information, please contact Joe Ryan at 651-895-3502.

**Please note:** If more than one sponsor is interested in the Back or Inside Back Cover, you will be contacted to submit a blind bid for that space. Thank you.

Please make checks payable to: **AFE Chapter 13**

**Mail to:** AFE Twin Cities Chapter 13  
 1960 Cliff Lake Rd, Suite 129-409  
 Eagan, MN 55122

Federal Tax ID # 41-1742092

Invoice # 2011-900 (if needed)

## Project Showcase

The Directory Committee is excited to offer an outstanding opportunity to enhance your sponsorship of Twin Cities Chapter 13 through the Annual Directory of Members and Sponsoring Companies. The Project Showcase is intended for those wishing to have a full-page color ad. This program has two exciting parts:

### Part 1:

Sponsoring Companies are invited to submit a facility based photo and a detailed description of a project, application, or solution (please see attached submittal form). This submittal will be featured in section five (Sponsoring Companies) of the annual directory. It will be treated similar to a display ad with regards to cost, placement, and submission (please see enclosed Directory Advertising Form). It is not intended to replace display ads but to offer an enhanced method to demonstrate sponsoring company capabilities.

#### Benefit

- To offer an alternative method of advertising to showcase our Sponsoring Companies and bring more exposure and value to them.
- To further educate our members of latest facility based technologies, practices, and industry solutions.

Part 2: Project Showcase submissions will be gathered by the Directory Committee and presented to the AFE Twin Cities Chapter 13 Executive Board at the November Board Meeting. The Board will select the Project Showcase submittal they feel is most appropriate for the (drum roll please)...

## Cover of The Annual Directory of Members and Sponsoring Companies

#### Benefit

- The winning submittal will have their photo submittal enlarged to fit the entire front cover of the Directory.
- The winning submittal will have their submittal description featured on the inside front cover of the Directory.
- The winning submittal will have their entire submittal featured on AFE Chapter 13's Website Homepage for all of 2011!!!
- The winning submittal will be announced at the January Kick-Off member meeting.
- All of the benefits from Part 1.

We hope you take this opportunity to increase your participation and benefit from this exciting program from AFE Twin Cities Chapter 13. All of the necessary paperwork to get started with your submittal is included with this letter. Should you have any questions, please don't hesitate to contact Joe Ryan at (651) 895-3502 or [contact@afetwincities.org](mailto:contact@afetwincities.org).

Sincerely,  
The Directory Committee

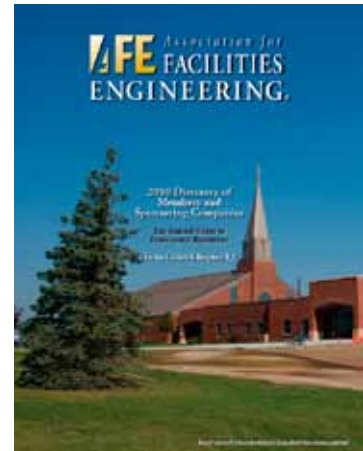

## 2011 PROJECT SHOWCASE & DIRECTORY COVER SUBMITTAL FORM

Listed below is the suggested guideline for the Project Showcase Directory Cover Submittal. Please complete this form and send it with your Directory Ad Form or your invoice (if previous sponsor). Please feel free to submit an alternative format. Please remember, these are guidelines only. We understand that clients, applications, solutions, technologies, strategies, etc. may be proprietary and need to be described in somewhat generalized terms.

**Your Company** \_\_\_\_\_

**Primary Contact** \_\_\_\_\_

**Phone** \_\_\_\_\_ **Mobile Phone** \_\_\_\_\_

Project Name: (If applicable)	
Project Managers: (or company/contractor individuals involved)	
Contractor Companies involved in the project: (architecture, engineering, construction, etc.)	
Your client	
Your client's application need or requirement (upgrade, problem, new application, retrofit, new construction, etc.)	
Proposed solution or recommendation: (include equipment, materials, technologies, strategies, etc.)	
Client benefits	
Additional project information	
Your Contact information	
Photography	High resolution. JPG and Tiff formats desired.
Company Logos	High resolution. Vector graphic format desired.
Basic layout design needed?	Yes / No (Contact Joe Ryan at 651-895-3502 to arrange)

Artwork deadline is **November 19, 2010**. **High resolution** electronic artwork should be emailed to [contact@afetwincities.org](mailto:contact@afetwincities.org). Camera ready or hard copy artwork should be mailed with your Directory Ad Form and payment. Basic layout design can be performed by AFE's designer. For those needing basic layout design, please complete the text portion (this form) of your submittal in MS Word format or equivalent. If you have any questions or require additional information, please contact Joe Ryan at 651-895-3502.

## Sponsorship Opportunities

In an effort to more clearly communicate the sponsorship opportunities available through AFE Twin Cities Chapter 13, the executive board agreed to publish these opportunities in each of our newsletters. If you are interested in learning more about any of the sponsorship programs, please check out the "Sponsorship" button on our website or contact the "Sponsoring Companies" Executive Board Liaison listed in our Annual Directory. We welcome your input on any of these opportunities. Thank you.

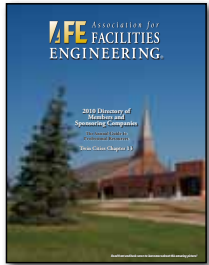

### Annual Directory of Members and Sponsoring Companies

This publication has been the most popular sponsoring tool for many years. It is a comprehensive directory of the Executive Board, Committee Members, Chapter Principles and Bylaws, Chapter Members, and Sponsoring Companies. Members use this directory as a facility supplier and peer resource. Sponsoring Companies are offered several advertising methods in a "Yellow Pages" style section. A new feature of this publication is called "Project Showcase." This advertising opportunity allows Sponsoring Companies to submit a photo and project description. These submittals are reviewed and voted on by the Executive Board. The photo from the winning submittal is then used for the cover of the Directory and the masthead for AFE Twin Cities Chapter 13 website and newsletter. A full page description of the project is also featured on the inside front cover of the Directory. The cost to advertise in the Directory ranges from \$100-\$900.



### Monthly Meeting Sponsorship

Sponsorship of a monthly meeting was rated the overall best value in a survey conducted in 2004. A monthly meeting generally consists of three components: 1) A plant or facility based tour for members 2) A related 30-45 minute presentation 3) Social Hour and dinner with all attendees. These meetings are held on the third Monday of the month from 5:00-7:30pm approximately 7-8 times per year. Cost ranges from \$750-\$1500 depending on attendance and dinner/social arrangements. Included with sponsorship is a full page ad in our monthly newsletter. If you are interested in sponsoring a monthly meeting, please contact the Programs Chairperson from our Executive Board. Preparations for these events is planned six months to one year prior to the event, so please contact us well in advance.



### Lucky 13 Golf Tournament

The "Lucky 13" Golf Committee organizes an annual golf tournament at the beautiful Hudson Country Club. Held on the third Monday in July, the tournament brags that it has never been rained on since its inaugural event in 1989. Use ink to put this one on the calendar. Representatives from sponsoring companies have the opportunity to invite plant managers for an great 18-hole round of golf played in a scramble format. There are long drive, closest-to-the-pin, hole-in-one, and some...*non-traditional* contests to keep the day exciting. Golf shirts, towels, and beverages are also available for sponsorship. Lunch, and a wonderful dinner provided by the famous Pork-O-Call, and prizes are all included. Participation cost is \$90-\$110. Hole sponsorship cost is \$275. Shirt, towel, and beverage sponsorship ranges from \$500-\$3000. Proceeds from the event help fund the Student Scholarship Program.



### Newsletter Sponsorship

AFE Twin Cities Chapter 13 publishes a newsletter approximately ten times per year. The newsletter features meeting details, certification and educational information, community events, and current events. It is distributed to approximately 250 plant managers and 150 facility industry suppliers. Typically a 1-2 page advertisement is submitted and inserted into the newsletter. The cost for one month is \$150.

## Certification & Recertification

The Association for Facilities Engineering offers its Certified Plant Engineer, Certified Plant Maintenance Manager, and Certified Plant Supervisor programs at selected cities across the country. All programs require certain levels of education and/or experience for eligibility and completion of an application.



The CPE program provides a standard of competence for facilities engineers and managers. Its curriculum covers

civil engineering, economics, management, environmental engineering, safety, maintenance, mechanical engineering, HVAC and electrical engineering.



The CPMM program debuted in 1999 to provide a standard of professional competence for maintenance managers and to enhance the status of this field as a unique discipline and profession.

It is built on the success of the CPE program. The curriculum consists of the following sections: maintenance management, preventive maintenance, inventory and procurement, work orders - work flow/planning and scheduling, CMMS, training and work cultures, predictive maintenance, reliability centered maintenance, total productive maintenance, maintenance financials and return on investment.



The CPS review program has been designed for the supervisory professional or

those aspiring to fill the ranks of supervision. Our uniquely designed curricula guide you through the most relevant materials to ensure maximum retention for the plant/facility supervisor. Basic supervision requires individuals understand and can exhibit what to do in the face of change, effective communication skills, how to empower employees, and how to enable them to develop the confidence to overcome the daily challenges they face.

## Certification & Recertification Eligibility Matrix

TITLE	EXPERIENCE	EDUCATION	EXAM REQ	PREPARATION	RECERTIFICATION REQUIREMENTS
CPE	Minimum 4 yrs in management in plant/facility engineering (OR) 6 yrs in field overall	4-yr degree in engineering, architecture or related field	YES	3-6 months reviewing CPE Review Pak study materials, previous experience in application of various engineering principles, participation in review program	8 Credits in 3 Years
CPE	Minimum 6 yrs in management in plant/facility engineering (OR) 8 yrs in field overall	No degree required	YES	3-6 months reviewing CPE Review Pak study materials, previous experience in application of various engineering principles, and participation in review program	8 Credits in 3 Years
CPE	Minimum 4 yrs experience as a registered professional engineer		NO		8 Credits in 3 Years
CPMM	Minimum 2 yrs in maintenance management	No degree required	YES	4-6 weeks reviewing CPMM Review Pak study materials and/or participation in review program	5 Credits in 3 Years
CPS	Minimum 2 yrs in plant/facility supervisory capacity (OR) Minimum 3 yrs in field overall	No degree required	YES	4-6 weeks reviewing CPS Review Pak study materials and/or participation in review program	5 Credits in 3 Years

## 2009-2010 Program & Event Schedule

### 2010 Program & Event Schedule

**January 16**

Trane Facility Tour  
Measuring & Rating Building Performance

**February 15**

University of Wisconsin - Stout Facility & Campus Tour  
Joint meeting with Eau Claire Chapter 66  
and Stout Student Chapter

**March 16 (Tuesday)**

INSPEC CEU Event  
Minnesota Chief Engineers Guild

**April 19**

Enlow Companies Power Quality Tour  
Advanced Energy Design and Achieving 30%  
Energy Savings Toward a Net Zero Energy Building.

**July 19**

*"Lucky 13"* Golf Tournament  
Hudson Golf Club

**August 20th**

Family Night  
St. Paul Saints Baseball Game  
Midway Stadium

**September 20**

Vadnais Heights Sports Complex  
Sponsored by Schwickerts

**October 18**

St. Joe's Facility Tour  
Sponsored by Harris Controls

**November 15**

Vendor Fair & Awards Banquet  
Installation of 2011 Executive Board of Directors  
Member and Sponsor Recognition

**December**

No meeting scheduled

### 2009 Program & Event Schedule

**January 19**

Great River Energy Tour  
Sponsored by Dunham Associates and Perkins & Will

**February 19**

CEU Seminar - Meeting with the Experts  
Sponsored by INSPEC, Inc.

**March 23**

Restoration Professionals Facility Tour  
Sponsored by Restoration Professionals

**April 20**

TMI Coatings Facility Tour  
Sponsored by TMI Coatings

**May 26**

Children's Hospital Power Plant Tour  
Sponsored by Harris Controls

**June 29 Couples Night**

Excelsior Bay Charters Boat Cruise

*"Lucky 13"* Golf Tournament  
Hudson Golf Club

**September 21**

East Ridge High School Tour  
Sponsored by Hallberg Engineering

**October 19**

Converted Grain Belt Brewhouse  
Sponsored by Liesch Associates

**October 28-29**

Midwest Facilities Expo  
Minneapolis Convention Center

**November 16**

Vendor Fair & Awards Banquet  
Installation of 2010 Executive Board of Directors  
Member and Sponsor Recognition

**December**

No meeting scheduled

## 2010 Executive Board of Directors

### **President**

Vince Rost, CPMM  
Executive Board Speaker & Committees Chair  
Aspen Research  
White Bear Lake, MN  
651-264-6242



### **1st Vice-President**

Paul Solmon, CPMM  
Program Chair & Newsletter Editor  
Saint Thomas Academy  
Mendota Heights, MN  
651-683-1536



### **2nd Vice-President**

Dave Fergus, PE  
Membership & Education Committee Liaison  
Darragh Machine Works, Lakeville, MN  
Dynetic Systems Corp., Elk River, MN  
763-441-4300



### **Treasurer**

Brian Cornelisse  
Trade Show Committee Liaison  
Harris Controls  
St. Paul, MN  
651-602-6573



### **Secretary**

Al Meinke  
Sponsoring Companies & Directory Committee Liaison  
Skyline Displays  
Eagan, MN  
651-234-6902



### **Past President**

Tom Westby  
Student Chapter Committee Liaison  
Rochester, MN  
507-292-7846



## Contact us

1960 Cliff Lake Road  
Suite 129-409  
Eagan, MN 55122

651-895-3502  
651-905-9535 fax

[www.afetwincities.org](http://www.afetwincities.org)  
[contact@afetwincities.org](mailto:contact@afetwincities.org)

## 2010 Newsletter Submission Calendar

The target dates for the monthly AFE newsletter are listed below. All article submissions or newsletter and or program questions should be addressed to:

Paul Solmon, CPMM  
St. Thomas Academy  
949 Mendota Heights Road | Mendota Heights, MN 55120  
(651) 683-1536 | [psolmon@cadets.com](mailto:psolmon@cadets.com)

<b>MONTH</b>	<b>ARTICLE DEADLINE</b>	<b>NEWSLETTER SENT</b>
November	October 26	November 2
December	November 30	December 7



## Mission Statement

*The Association for Facilities Engineering provides education, certification, technical information and other relevant resources for plant and facility engineering, operations and maintenance professionals worldwide.*